

32 809 000 BAUCURVE PILLAR TAP 1/2"

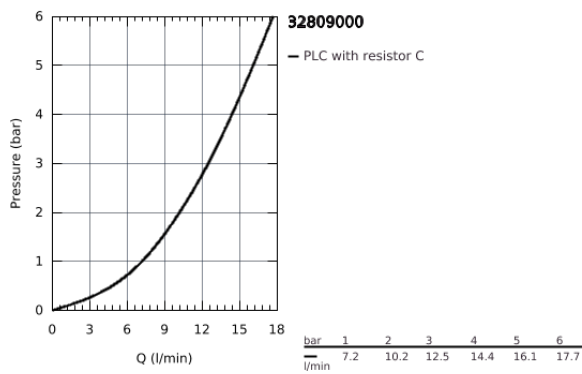

PRODUCT DESCRIPTION

- single hole installation
- metal lever
- GROHE Longlife 28 mm ceramic cartridge
- **GROHE StarLight** chrome finish
- mousseur
- fixation nut

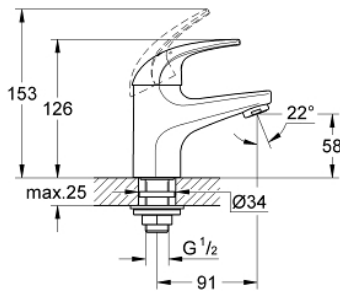

32 809 000 **BAUCURVE PILLAR TAP 1/2"**

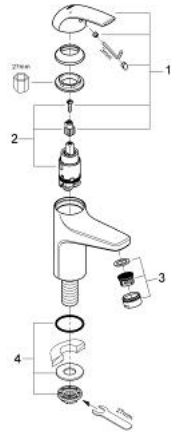

SPARE PARTS

- 1: Lever (Order-nr. 46699000)
- 2: Cartridge (Order-nr. 46580000)
- 3: Mousseur (Order-nr. 13952000)
- 4: Shank fastening assembly (Order-nr. 45004000)