

31 831 001 **COSTA L SINK MIXER 1/2"**

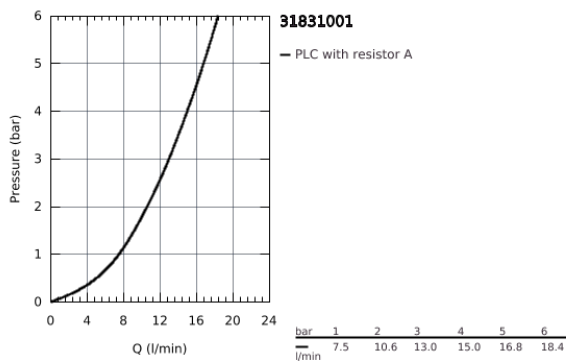

PRODUCT DESCRIPTION

- metal handles
- heat-insulated
- **GROHE StarLight** finish
- Longlife-headparts
- mousseur
- swivel tubular spout
- swivel area 360°
- flexible connection hoses

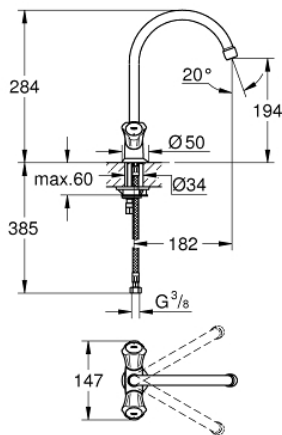

31 831 001 COSTA L SINK MIXER 1/2"

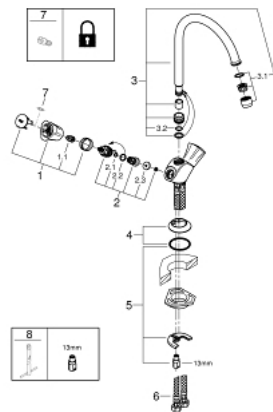

SPARE PARTS, September 2016 – now

- 1: Handle Costa L (Order-nr. 45994000)
 - 1.1: Snap insert (Order-nr. 0538600M)
 - 2: Headpart 1/2" (Order-nr. 07146000)
 - 2.1: O-Ring $\varnothing 6 \times \varnothing 2$ (Order-nr. 0128300M)
 - 2.2: O-Ring $\varnothing 18,2 \times \varnothing 1,7$ (Order-nr. 0392400M)
 - 2.3: Sealing washer (Order-nr. 0529100M)
 - 3: Biflo spout (Order-nr. 13213000)
 - 3.1: Flow restrictor (Order-nr. 13928000)
 - 3.2: O-ring dia. 12x2 mm (Order-nr. 0128000M)
 - 4: Escutcheon (Order-nr. 45996000)
 - 5: Shank mounting kit (Order-nr. 46249000)
 - 6: Connection hose (Order-nr. 46255000)
 - 7: Screw for Costa/Avina products (Order-nr. 48013000)*
 - 8: Mounting wrench (Order-nr. 19017000)*
- * Optional accessories