

31 358 002 MINTA TOUCH ELECTRONIC SINGLE-LEVER SINK MIXER 1/2"



PRODUCT DESCRIPTION

- C-spout
- monobloc installation
- **Touch: activation of water via skin contact**
- **battery supply** 6 V lithium-battery, type CR-P2
- CE approved
- solenoid valve
- fixed value mixing valve
- automatically stops after 60 sec. (factory set)
- type of protection IP 44
- **GROHE StarLight** chrome finish
- **GROHE SilkMove** 46 mm ceramic cartridge
- pull-out dual spray
- diverter: laminar spray/SpeedClean shower jet
- swivel tubular spout
- swivel area 360°
- protected against backflow

- flexible connection hoses

- rapid installation system

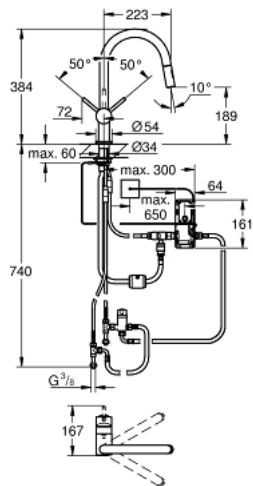

31 358 002 MINTA TOUCH ELECTRONIC SINGLE-LEVER SINK MIXER 1/2"

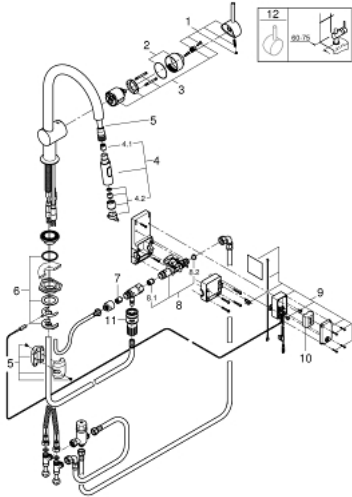

SPARE PARTS, July 2017 – now

- 1: Lever (Order-nr. 46015000)
- 2: Shield for cross handle (Order-nr. 46025000)
- 3: Cartridge (Order-nr. 46048000)
- 4: Hand shower (Order-nr. 48416000)
- 4.1: Non-return valve (Order-nr. 08565000)
- 4.2: Flow straightener (Order-nr. 48347000)
- 5: Shower hose (Order-nr. 48293000)
- 6: Shank mounting kit (Order-nr. 46345000)
- 7: Non-return valve (Order-nr. 08565000)
- 8: Solenoid valve (Order-nr. 48213000)
- 8.1: Non-return valve (Order-nr. 08565000)
- 8.2: Strainer (Order-nr. 42395000)
- 9: Control unit (Order-nr. 48214000)
- 10: Battery (Order-nr. 42886000)
- 11: Coupling piece (Order-nr. 46338000)
- 12: Lever (Order-nr. 40684000)*

* Optional accessories